

Dated.....*8th August*.....2024

**THE CITY OF BRADFORD METROPOLITAN DISTRICT COUNCIL  
(TOLLER LANE AND WHETLEY HILL, BRADFORD)  
(HIGHWAY JUNCTION IMPROVEMENT SCHEME)  
COMPULSORY PURCHASE ORDER 2021**

**GENERAL VESTING DECLARATION**

**-made and executed by-**

**The City of Bradford Metropolitan District Council**

**-pursuant to-**

**The Compulsory Purchase (Vesting Declarations) Act 1981**

**-in respect of -**

**Leasehold Estate comprising 22 square metres of land comprising part of the frontage  
to No 118 Whetley Hill, Bradford BD8 8NA**

**Jason Field  
Director of Legal and Governance  
Department of Corporate Resources,  
The City of Bradford Metropolitan District Council,  
City Hall, Centenary Square, Bradford  
West Yorkshire BD1 1HY**

This **GENERAL VESTING DECLARATION** is executed on the 8<sup>th</sup> day of August 2024

by The City of Bradford Metropolitan District Council ("**the Authority**")

**WHEREAS**

On 16<sup>th</sup> July 2021 an order entitled The City of Bradford Metropolitan District Council (Toller Lane and Whetley Hill, Bradford) (Highway Junction Improvement Scheme) Compulsory Purchase Order 2021 was confirmed by the Secretary of State for Transport under the powers conferred on him by the Highways Act 1980 authorising the Authority to acquire the land specified in the Schedule hereto.

Notice of confirmation of the order was first published in accordance with section 15 of the Acquisition of Land Act 1981 on 19<sup>th</sup> August 2021.

That notice included the statement and form prescribed under section 15(4) (e) and (f) of the Acquisition of Land Act 1981.

**NOW THIS DEED WITNESSETH** that, in exercise of the powers conferred on them by section 4 of the Compulsory Purchase (Vesting Declarations) Act 1981 ("**the Act**"), the Authority hereby declare the land described in the Schedule hereto being part of the land authorised to be acquired by the order and more particularly delineated on the plan annexed hereto, together with the right to enter and take possession of the land shall vest in the Authority as from the end of the period of three months from the date on which the service of notices required by section 6 of the Act is completed.

**SCHEDULE**

**ALL THAT** leasehold estate comprising 22 square metres of land forming part of the frontage to No 118 Whetley Hill, Bradford, as shown more particularly delineated and edged red on the plan annexed hereto, being part of the land in a Lease registered at HM Land Registry under Title number WYK321402.

**EXECUTED** as a **DEED** by affixing  
the **COMMON SEAL** of  
**The City of Bradford Metropolitan District Council**  
in the presence of



Authorised Signatory



103577A

Dated 8 August 2024

MA 7

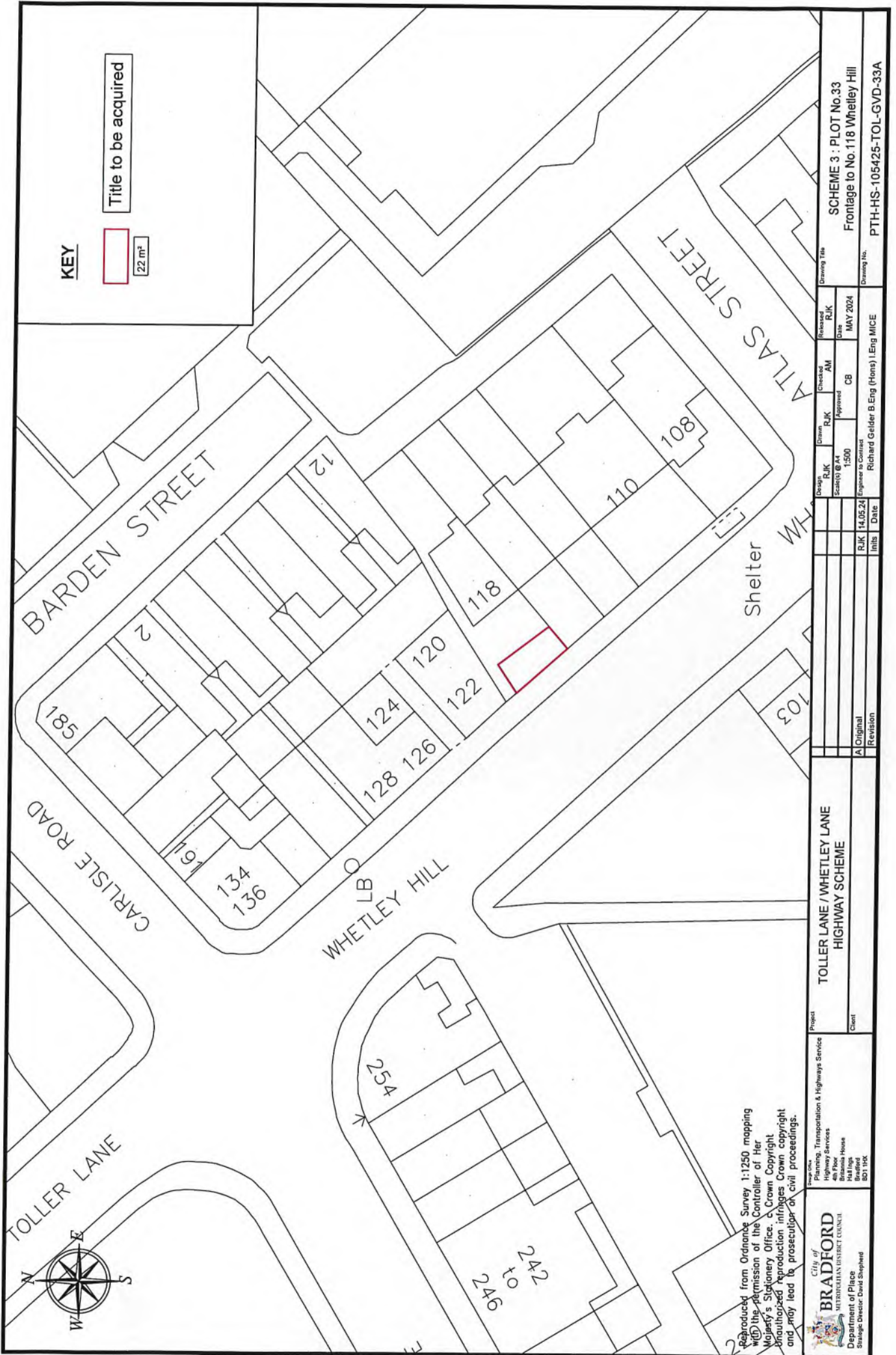

**KEY**  
 22 m<sup>2</sup>  
 Title to be acquired

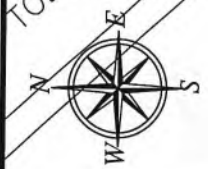

Reproduced from Ordnance Survey 1:1250 mapping with the permission of the Controller of Her Majesty's Stationery Office. Crown Copyright. Unauthorized reproduction infringes Crown copyright and may lead to prosecution or civil proceedings.

**City of BRADFORD**  
 METROPOLITAN DISTRICT COUNCIL  
 Department of Place  
 Strategic Director David Shepherd

Project  
 Planning, Transportation & Highways Service  
 Highway Services  
 4th Floor  
 Business House  
 Beckett  
 BD1 1HX

TOLLER LANE /WHETLEY LANE  
 HIGHWAY SCHEME

Revision	Initials	Date
A Original	RJK	14.05.24

Design: RJK  
 Scale: @ A4  
 1:500  
 Engineer in Charge: Richard Gilder B.Eng (Hons) | Eng MICE

Checked: AM  
 Approved: CB  
 Released: RJK  
 Date: MAY 2024

Drawing Title: SCHEME 3 : PLOT No.33  
 Frontage to No.118 Whetley Hill  
 Drawing No.: PTH-HS-105425-TOL-GVD-33A

